

First Floor

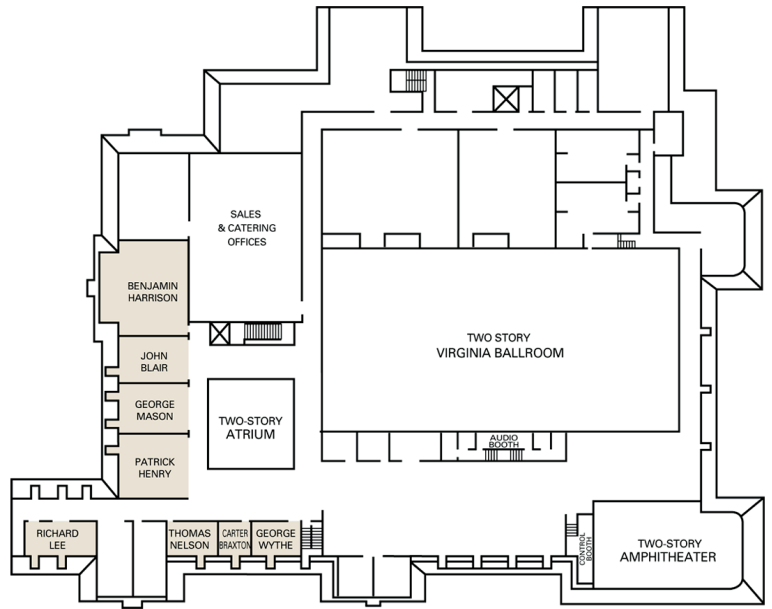

Second Floor

	SQUARE FEET	DIMENSIONS Width x Length	CEILING HEIGHT	THEATER STYLE	CLASS ROOM	HOLLOW SQUARE	RECEPTION	8X10 EXHIBITS	BANQUET ROUNDS
VIRGINIA BALLROOM	12876	148' X 87'	15'	1400	700	—	1400	80	1000
1	3160	37'x 87'	15'	280	120	60	230	18	180
2	3219	37'x 87'	15'	300	140	60	250	18	210
3	3219	37'x 87'	15'	300	140	60	250	20	210
4	3306	37'x 87'	15'	280	120	60	230	18	180
1, 2, 3	9570	111'x 87'	15'	880	400	—	730	55	600
2, 3, 4	9570	111'x 87'	15'	880	400	—	730	55	600
1, 2	6350	74'x 87'	15'	580	260	—	480	36	390
3, 4	6525	74'x 87'	15'	580	260	—	480	36	390
1A	1580	37'x 43'6"	15'	140	50	48	110	10	80
1B	1580	37'x 43'6"	15'	140	50	48	110	10	80
4A	1653	37'x 43'6"	15'	140	50	48	110	10	80
4B	1653	37'x 43'6"	15'	140	50	48	110	10	80
Ballroom Foyer	4590	51'x 90'	12	—	—	—	400	25	200

	SQUARE FEET	DIMENSIONS Width x Length	CEILING HEIGHT	THEATER STYLE	CLASS ROOM	HOLLOW SQUARE	RECEPTION	8x10 EXHIBITS	BANQUET ROUNDS
MEETING ROOMS									
Thomas Jefferson Amphitheater	2613	39'x 67'	16'	—	80	—	—	—	—
Harrison	1402	39'1"x 27'7"	10'	80	50	40	80	5	80
Franklin	1344	32'8"x 42'6"	10'	80	50	44	90	10	90
Madison	1344	32'8"x 42'6"	10'	80	50	44	90	10	90
Wentworth Boardroom	820	20'x 41'	10'	—	—	14	—	—	—
Henry	755	26'6"x 28'7"	10'	60	40	30	50	5	50
Blair	584	20'5"x 28'1"	10'	40	24	24	40	4	40
Mason	584	20'5"x 28'7"	10'	40	24	24	40	4	40
Lee	433	29'9"x 14'6"	9'	24	16	18	20	4	20
Wythe	309	21'4"x 14'6"	9'	16	12	—	20	10	20
Nelson	294	20'3"x 14'6"	9'	16	12	—	15	10	20
Braxton	213	14'8"x 14'6"	9'	12	6	—	10	6	10
Swan Terrace	5200	52'x 100'	14'	—	—	—	180	—	150
English Gardens	4050	45'x 90'	Outside	500	—	—	800	—	250
Atrium	1296	36'x 36'	32'	200	—	—	150	5	100
Fireplace Lobby	1575	35'x 45'	12'	90	—	—	150	—	90